

Notes: Fence Angles
Are Approximate

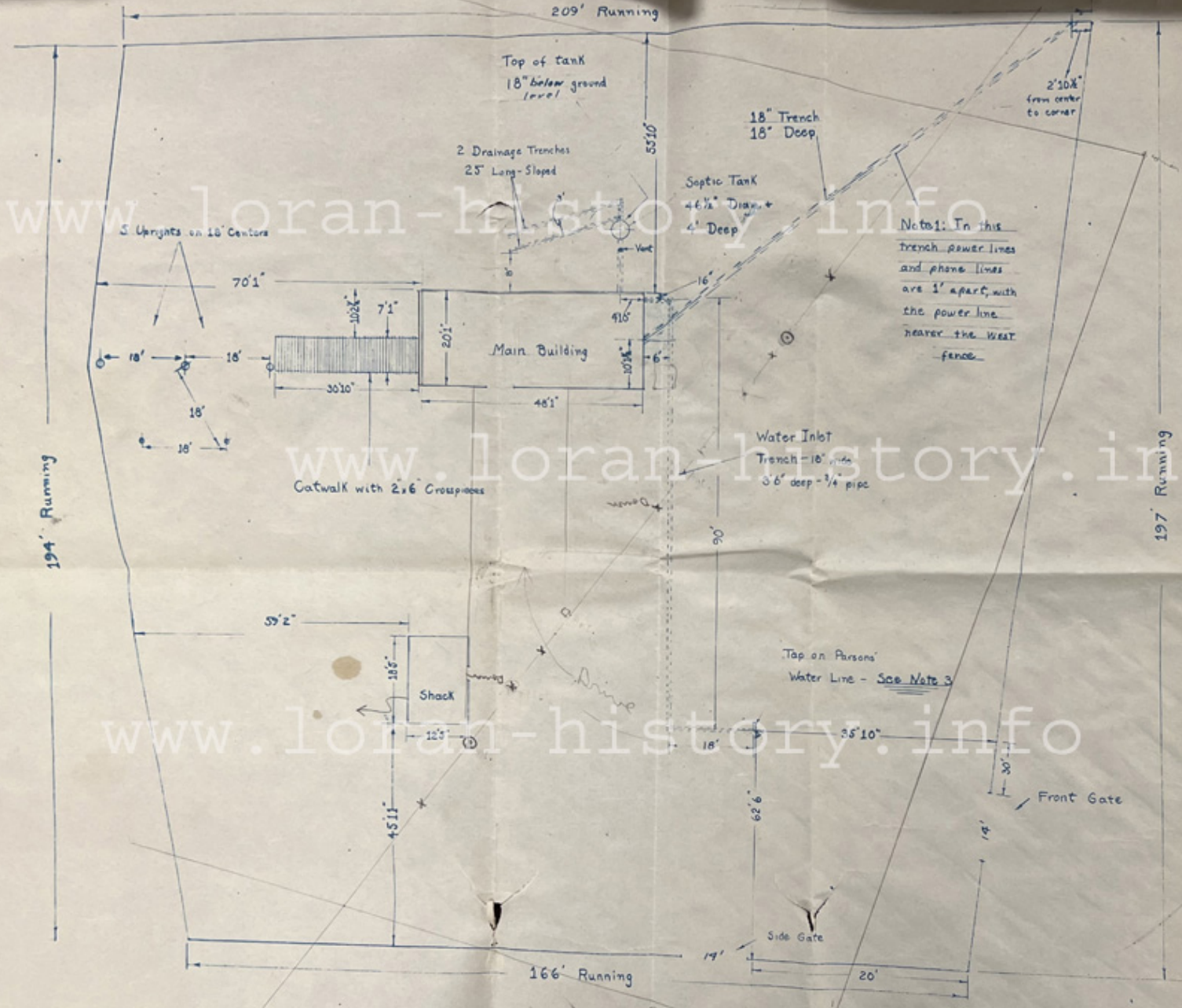

Note 3: Location of tap-off point from fences is off scale because of fence angle approximations. Dimensions given are correct otherwise.

Note 1: In this trench power lines and phone lines are 1' apart, with the power line nearer the West fence.

Tap on Parsons' Water Line - See Note 3



Preliminary copy
GROUND PLAN OF
Hither Plains R.D.F. Station

SCALE 1/8" = 1'

APPROVED	DRAWN BY G.E.W.	CHECKED BY
	TRACED BY	ENGINEER

DIMENSIONS UP TO AND INCLUDING 72 INCHES EXPRESSED IN INCHES

BELL TELEPHONE LABORATORIES, INC. NEW YORK